

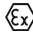

POINT WIND CONE PWC-AX2 LED ATEX & IECEX ZONE 2

Compliances: FAA Advisory Circular 150/5390-27E Windsock
 ICAO Annex 14, Volume II Heliports, Paragraph 5.1
 Transport Canada TP312, Chapter 5 Visual Aids
 UK CAA CAP 437 & American Bureau of Shipping (ABS)
 IECEx Listed: Ex ec IIC T5 Gc -40 to +55-deg C, IP66
 ATEX Listed:  ec IIC T5 Gc -40 to +55-deg C, IP66
 Listed to UL 844 & UL 1598
 Listed to UL 1598A Marine Vessels
 Listed to CSA C22.2 No. 137-M1981 Canada



A wind cone is used to visually indicate wind direction at airports and heliports. Point Lighting wind cones are installed at offshore helidecks, heliport, hospitals, corporate headquarters and military bases around the world. ATEX & IECEx lighting is used for hazardous area requirements.

FAA Type	Size	Lighting	Power	Windsock	Rating	Options
PWC-806	1: 8-ft Sock FAA Size 1 4: 1.2m Sock ICAO	L: Lighted Style I	2: AC* * AC range is 108-250V; 50/60Hz	ON: Orange Nylon RW: Red/White	AX2: ATEX & IECEx Zone 2	OL: Obstruction Light SM: Stand Mount FM: Flange Mount

Size 1: 8-ft sock has 18-inch diameter frame
 Size 4: 4-ft sock per ICAO, PEMEX & HSAC

IECEx SIR 17.0085X
 Sira 17ATEX9365X

Floodlight:

ABS Certificate Number: 18-HS1714308-PDA
 Power – Floodlight: 34 watts

Obstruction Light:

ABS Certificate Number: 15HS1325629-PDA
 Power – Obstruction: 2.1 watts

SPARE PARTS

- PL11428-1 Floodlight Assembly
- PL11282-1 Obstacle Light
- PL10063-CH Windsock Size 1
- PL10996 Windsock Size 4
- PL10289 Basket Subassembly Size 1



PWC-AX2 LED WIND CONE
 TYPE 806 ATEX & IECEX ZONE 2



Pole is Stainless Steel 316L



POINT
LIGHTING
CORPORATION

POINT WIND CONE PWC-AX2 LED ATEX & IECEX ZONE 2

PWC-AX2 LED WIND CONE
TYPE 806 ATEX & IECEX ZONE 2



OPTION -FM FLANGE MOUNT

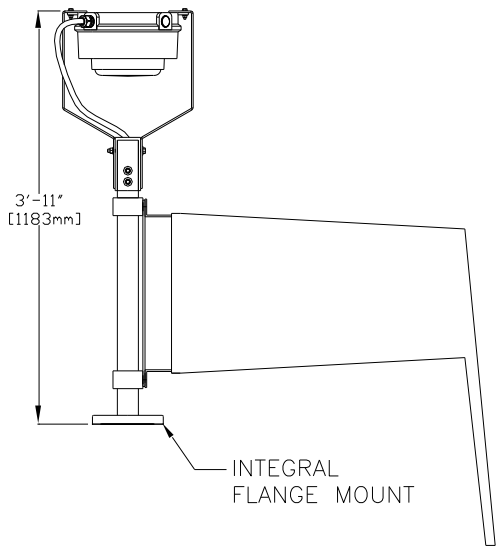

FLANGE MOUNT BOLT PATTERN

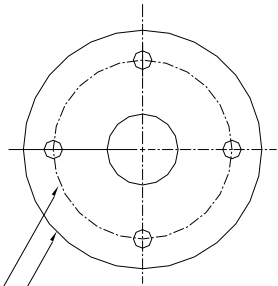

- FLANGE DIAMETER:
8-INCH [203mm]
- BOLT CIRCLE DIAMETER:
6-INCH [152mm]
- MOUNTING HOLES DIAMETER:
QTY 4: 9/16-INCH [14]



POINT
LIGHTING
CORPORATION

POINT WIND CONE
PWC-AX2 LED
ATEX & IECEx ZONE 2

